

ITEM	DESCRIPTION	QUANTITY	PART NUMBER	WEIGHT (lbs.)	PUMP ASSEMBLY (31078366)	POWERHEAD ASSEMBLY (31081620)	REBUILD KIT (44078367)	SEAL KIT (33078170)
1	Impeller	1	31065169	13	✓	✓	✓	
2	Volute	1	31064270	25.8	✓	✓		
3	Shaft	1	31064939	5	✓	✓	✓	
4	Seal, Mechanical	1	33011197	0.28	✓	✓	✓	✗
5	Head, Suction	1	31066692	6.2	✓	✓	✓	
6	Key	1	29024598	0.03	✓	✓	✓	✗
7	Gasket	2	33015120	0.01	✓	✓	✓	✗
8	Housing, Bearing	1	31032147	7.8	✓	✓	✓	
9	Nut	1	15066365	0.12	✓	✓	✓	✗
10	Washer, Flat	1	15066700	0.03	✓	✓	✓	✗
11	Adapter	1	01025390	6.6	✓	✓		
12	Adapter	1	01064941	4.6	✓	✓		
13	Bearing, Bronze	1	04066693	0.4	✓	✓	✓	
14	Seal, Oil	1	33025458	0.4	✓	✓	✓	✗
15	O-Ring	1	33072523	0.6	✓	✓	✓	✗
16	Bearing, Ball	1	04076808	1.12	✓	✓	✓	
17	Ring, Snap	1	15028537	0.04	✓	✓	✓	
18	Ring, Snap	2	15025457	0.03	✓	✓	✓	
19	Coupling	1	10062399	1.00	✓	✓		
20	Gasket	1	33033079	0.01	✓	✓	✓	✗
21	Stud	6	15026388	0.04	✓	✓	✓	
22	Bolt	16	15030858	0.04	✓	✓		
23	Bolt	8	15030858	0.04	✓	✓		
24	Bolt	4	15030861	0.04	✓	✓		
25	Washer, Lock	20	15031068	0.01	✓	✓		
26	Washer, Lock	12	15031068	0.01	✓	✓		
27	Washer, Lock	6	15031070	0.01	✓	✓	✓	
28	Nut	6	15031040	0.02	✓	✓	✓	
29	Bushing	1	18030569	0.01	✓			
30	Vent, Pressure	1	16014839	0.01	✓			
31	Plug	3	18030530	0.02	✓			
32	Plug	3	18031653	0.01	✓			
33	Pump Assembly	1	31078366	79.64				
34	Powerhead Assembly	1	31081620	42.13				
35	Rebuild Kit	1	44078367	21.53				
36	Seal Kit	1	33078170	1.49				

WATEREND, PUMP ASSEMBLY
Series: H
Part #: 31078366

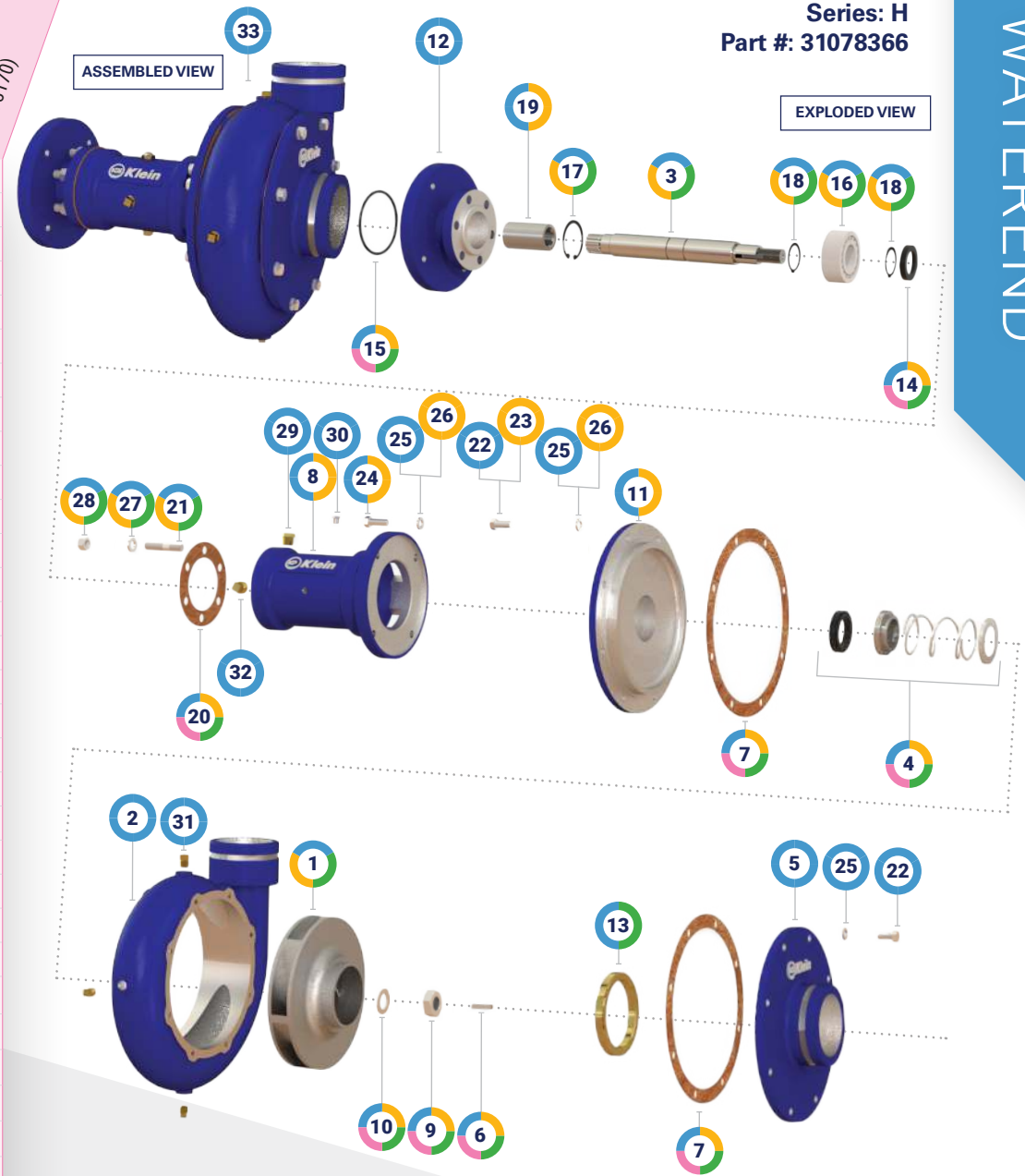

- > Hydraulic
- > 4" Grooved inlet x 3.5" grooved outlet
- > Rotation: Clockwise
- > Pump manual